

- (1). What is the minimum strength of concrete on an unreinforced foundation for a single storey home?
- 10MPa
  - 15MPa
  - 20MPa
  - 25MPa
- (2). The strength of the concrete should not be less than..... on the lower level of a Reinforced double storey building?
- 5MPa
  - 15MPa
  - 20MPa
  - 25MPa
- (3). What is the expected grade/strength of infill concrete in a cavity wall?
- 5 MPa
  - 10 MPa
  - 15 MPa
  - 25MPa

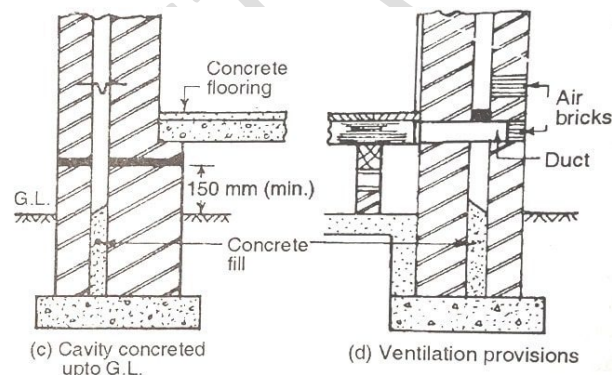

- (4). Basic uncomplicated foundations should be constructed with concrete that has a compressive strength of at least .....MPa at 28 days in the ratio?
- 05MPa, 1:2:2 Cement: Sand: Stone
  - 10MPa, 1:4:5 Cement: Sand: Stone
  - 15MPa, 1:1:1 Cement: Sand: Stone
  - 25MPa, 2:1:2 Cement: Sand: Stone

**Buy our 25-page summarized study guide for R600 which has the answer sheet to the above NHBRC test questions to guarantee a 100% success rate with the preparation of your exam. Click back to see option 1, 2 or 3 for more info. Deposit funds into FIXONATE's FNB Acc No: 62686499924, Code 250655 to receive the SMS Password to the study guide. Please use your cellphone number as the deposit reference. Call 072 547 5231 (24/7) for more information.**

- (5). The [redacted] strength of concrete for [redacted] concrete [redacted] items such as [redacted] should be?
- a) 15 MPa
  - b) 25 MPa
  - c) 30 MPa
  - d) 35 MPa
- (6). The [redacted] gained by concrete after [redacted] with respect to [redacted] grade?
- a) 80%
  - b) 99%
  - c) 100%
  - d) None of the above
- (7). Concrete shall have a minimum strength of... on unreinforced or reinforced [redacted]
- a) 05 MPa
  - b) 10 MPa
  - c) 15 MPa
  - d) 25 MPa
- (8). What is the minimum required compressive strength of [redacted] at [redacted]
- a) 5MPa
  - b) 7MPa
  - c) 10MPa
  - d) 14.5MPa
- (9). What is the Minimum [redacted] foundation?
- a) 150mm
  - b) 200mm
  - c) 300mm
  - d) 400mm
- (10). What is the [redacted] [redacted] of a continuous strip foundation for a [redacted]
- a) 200mm
  - b) 400mm
  - c) 600mm
  - d) 800mm

**Buy our 25-page summarized study guide for R600 which has the answer sheet to the above NHBRC test questions to guarantee a 100% success rate with the preparation of your exam. Click back to see option 1, 2 or 3 for more info. Deposit funds into FIXONATE's FNB Acc No: 62686499924, Code 250655 to receive the SMS Password to the study guide. Please use your cellphone number as the deposit reference. Call 072 547 5231 (24/7) for more information.**

- (11). What is the [REDACTED] of a strip foundation on C, H, R and S soil classification sites on reinforced concrete roofs?
- a) 400mm & 500mm
  - b) 600mm & 750mm
  - c) 800mm & 1000mm
  - d) 1000mm & 1200mm
- (12). The [REDACTED] of a [REDACTED] for a [REDACTED] with a tiled or sheeted roof in stable soil conditions for an external & internal wall shall be...respectively?
- a) 200mm for the external wall & 400mm for the internal wall
  - b) 400mm for the external wall & 200mm for the internal wall
  - c) 500mm for the external wall & 400mm for the internal wall
  - d) 400mm for the external wall & 500mm for the internal wall
- (13). What is the [REDACTED] in strip foundations?
- a) 1: 10
  - b) 1: 20
  - c) 1: 40
  - d) 1: 80
- (14). What is the maximum distance between a [REDACTED] (Please note: This question normally accompanied by a diagram showing a [REDACTED] to a stepped-up [REDACTED]).
- a) 600mm
  - b) 700mm
  - c) 1000mm or 1 Meter
  - d) 1300mm
- (15). What is the [REDACTED] of a strip foundation [REDACTED]
- a) 100mm
  - b) 400mm
  - c) 600mm
  - d) 700mm

**Buy our 25-page summarized study guide for R600 which has the answer sheet to the above NHBRC test questions to guarantee a 100% success rate with the preparation of your exam. Click back to see option 1, 2 or 3 for more info. Deposit funds into FIXONATE's FNB Acc No: 62686499924, Code 250655 to receive the SMS Password to the study guide. Please use your cellphone number as the deposit reference. Call 072 547 5231 (24/7) for more information.**

- (16). What is the [redacted] of a Non continuous strip foundation to a load bearing wall?
- a) 100mm
  - b) 400mm
  - c) 600mm
  - d) 700mm
- (17). What is the minimum width of [redacted] to an internal masonry [redacted]
- a) 100mm
  - b) 400mm
  - c) 600mm
  - d) 700mm
- (18). What is the [redacted] of a [redacted] that is not acting as a [redacted] ?
- a) 1.0 m
  - b) 1.5 m
  - c) 2.0 m
  - d) 2.5 m
- (19). What is the [redacted] of a [redacted] where the fill is [redacted] behind a [redacted] thickness?
- a) 0.4M
  - b) 0.7M
  - c) 0.9M
  - d) 1.8M
- (20). What will help increase the strength of [redacted] ?
- a) Decrease the water/concrete ratio
  - b) Decrease the amount of void in concrete by upgrading the concrete
  - c) Cure the concrete well
  - d) All of the above

**Buy our 25-page summarized study guide for R600 which has the answer sheet to the above NHBRC test questions to guarantee a 100% success rate with the preparation of your exam. Click back to see option 1, 2 or 3 for more info. Deposit funds into FIXONATE's FNB Acc No: 62686499924, Code 250655 to receive the SMS Password to the study guide. Please use your cellphone number as the deposit reference. Call 072 547 5231 (24/7) for more information.**

- (21). How can [REDACTED] be protected from [REDACTED]?
- a) Damp [REDACTED], cover it with [REDACTED] and spray the surface with water.
  - b) Damp [REDACTED], cover it with a [REDACTED] and spray the surface with water.
  - c) All of the above
  - d) None of the above
- (22). Why is concrete [REDACTED]?
- a) To eliminate [REDACTED] as well as to sustain a level surface
  - b) To make it [REDACTED]
  - c) To soften it for [REDACTED]
  - d) All of the above
- (23). What quality [REDACTED] is used for [REDACTED] mixing?
- a) Drinking (Potable) Water
  - b) Gray Water
  - c) Blackish water
  - d) River water
- (24). Reinforcing should be clean of..... before casting concrete?
- a) Rust [REDACTED] (General knowledge type of question).
  - b) Water & dirt.
  - c) Moisture & dirt.
  - d) All of the above.
- (25). The [REDACTED] shall be of such workability that it can be readily?
- a) The [REDACTED] be of such workability that it can be readily [REDACTED] into the corners of the framework and around reinforcement without segregation of the materials or excessive bleeding of free water at the surface.
  - b) Of the framework outside reinforcement without segregation of the materials
  - c) Of the framework inside unreinforcement without segregation of the materials
  - d) Of the framework inside unreinforcement with segregation of materials.

**Buy our 25-page summarized study guide for R600 which has the answer sheet to the above NHBRC test questions to guarantee a 100% success rate with the preparation of your exam. Click back to see option 1, 2 or 3 for more info. Deposit funds into FIXONATE's FNB Acc No: 62686499924, Code 250655 to receive the SMS Password to the study guide. Please use your cellphone number as the deposit reference. Call 072 547 5231 (24/7) for more information.**

- (26). What does a [REDACTED]
- a) [REDACTED] workability
  - b) [REDACTED] Strength
  - c) Dry or Wetness Density
  - d) Concrete Stress
- (27). In [REDACTED] used for [REDACTED], what should the [REDACTED] be?
- a) 3.0Mpa & 10.0MPa
  - b) 3.0MPa & 7.0MPa
  - c) 1.0 MPa & 10.0MPa
  - d) None of the above
- (28). What happens to the [REDACTED] when that type [REDACTED]?
- a) Fill it with mortar
  - b) Fill with concrete
  - c) Fill with iron bars for reinforcement
  - d) Leave as, it is [REDACTED]
- (29). We can use cement bricks to lift the surface bed rebar/mesh as long as the bricks are cut in half.
- a) True
  - b) False
  - c) [REDACTED]
  - d) [REDACTED]
- (30). Which of the following bricks [REDACTED] placed?
- a) Concrete bricks
  - b) Sand Lime Bricks
  - c) Clay bricks
  - d) None of the above

**Buy our 25-page summarized study guide for R600 which has the answer sheet to the above NHBRC test questions to guarantee a 100% success rate with the preparation of your exam. Click back to see option 1, 2 or 3 for more info. Deposit funds into FIXONATE's FNB Acc No: 62686499924, Code 250655 to receive the SMS Password to the study guide. Please use your cellphone number as the deposit reference. Call 072 547 5231 (24/7) for more information.**

(31). What happens to the [redacted] where the masonry is required to [redacted]

- a) The [redacted] can be filled with [redacted]
- b) The [redacted] can be filled with [redacted]
- c) The [redacted] can be filled with [redacted]
- d) All of the above.

(32). What is the concrete mix proportion for use with a [redacted] for [redacted] MPa?

- a) 1 bag cement (50kg), 2 wheelbarrow sand, 2 wheelbarrows stone, 80L water
- b) 1 bag cement (50kg), 1.5 wheelbarrow of sand, 1.5 wheelbarrow of stone, 30L water
- c) 2 bags cement (100kg), 2.5 wheelbarrow sand, 2.5 wheelbarrow stone, 50L water
- d) 2 bag cement, 2 wheelbarrows of sand, 2 wheelbarrows of stone.

N.B: The NHBRC can also ask this question in reverse by asking which of the following is the wrong mix proportion for use. Please always refer to table 4.2 in our study guide for any question that talks about concrete mixes

(33). [redacted] for [redacted]

- a) 1 bag cement (50kg), 2 wheelbarrow sand, 2 wheelbarrows stone, 80L water
- b) 1 bag cement (50kg), 1.5 wheelbarrow of sand, 1.5 wheelbarrow of stone, 30L water
- c) 2 bags cement (100kg), 4.5 wheelbarrow sand, 3 wheelbarrow stone, 66L water
- d) 2 bag cement, 2 wheelbarrows of sand, 2 wheelbarrows of stone, 55L water

(34). What is used [redacted]

- a) Silicon
- b) Rubber
- c) Mortar
- d) Nothing

(35). [redacted]

- a) Used after more water is added
- b) Discarded
- c) Used after more water and cement is added
- d) None of the above

**Buy our 25-page summarized study guide for R600 which has the answer sheet to the above NHBRC test questions to guarantee a 100% success rate with the preparation of your exam. Click back to see option 1, 2 or 3 for more info. Deposit funds into FIXONATE's FNB Acc No: 62686499924, Code 250655 to receive the SMS Password to the study guide. Please use your cellphone number as the deposit reference. Call 072 547 5231 (24/7) for more information.**

(36). Which one of the following are [REDACTED]

- a) Cracking
- b) Debonding
- c) Grinning
- d) All of the above

(37). What is the minimum [REDACTED]

- a) 10mm
- b) 25mm
- c) 35mm
- d) 45mm

(38). What is the maximum [REDACTED]

- a) 15mm
- b) 25mm
- c) 35mm
- d) 45mm

(39). What is the purpose of [REDACTED] ?

- a) To serve as bracing for floor joists
- b) Serve as a noise dampener
- c) To provide a vapour barrier to prevent moisture from coming in
- d) All of the above

(40).What is the [REDACTED] intake from the surface ground?

- a) 450mm
- b) 550mm
- c) 650mm
- d) 850mm

**Buy our 25-page summarized study guide for R600 which has the answer sheet to the above NHBRC test questions to guarantee a 100% success rate with the preparation of your exam. Click back to see option 1, 2 or 3 for more info. Deposit funds into FIXONATE's FNB Acc No: 62686499924, Code 250655 to receive the SMS Password to the study guide. Please use your cellphone number as the deposit reference. Call 072 547 5231 (24/7) for more information.**



(41). On [REDACTED], what is the minimum clearance between a [REDACTED]

- a) 250mm
- b) 450mm.
- c) 650mm
- d) 900mm

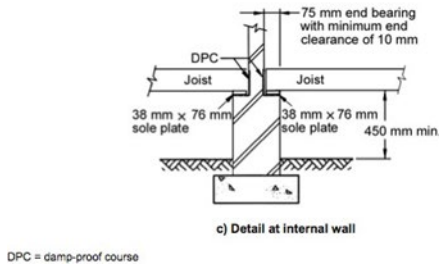
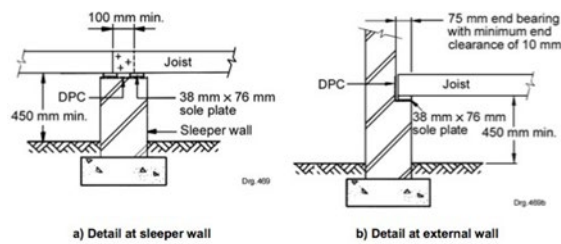

DPC = damp-proof course

(42). What is the minimum length of [REDACTED]

- a) 0mm
- b) 3mm
- c) 10mm
- d) 15mm

(43). What is the minimum required length of [REDACTED]

- a) 800mm
- b) 1000mm or 1 Meter
- c) 1200mm
- d) 1400mm

**Buy our 25-page summarized study guide for R600 which has the answer sheet to the above NHBRC test questions to guarantee a 100% success rate with the preparation of your exam. Click back to see option 1, 2 or 3 for more info. Deposit funds into FIXONATE's FNB Acc No: 62686499924, Code 250655 to receive the SMS Password to the study guide. Please use your cellphone number as the deposit reference. Call 072 547 5231 (24/7) for more information.**

- (44). What is the minimum required width of [REDACTED]?
- a) 150mm
  - b) 350mm
  - c) 600mm
  - d) 900mm
- (45). What is the minimum penetration depth for the [REDACTED]?
- a) 5mm
  - b) 10mm
  - c) 30mm
  - d) 60mm
- (46). Where would you apply [REDACTED]?
- a) Ceilings
  - b) In joineries
  - c) On floor boards
  - d) All of the above

Please Note: For NHBRC questions dealing with [REDACTED]  
[REDACTED]

- (47). Where would you apply [REDACTED] where the [REDACTED]?
- a) Laminated beams
  - b) Roof Trusses
  - c) Balustrades
  - d) All of the above
- (48). Where would you apply [REDACTED] where the [REDACTED]?
- a) Flooring Boards
  - b) Roof Trusses
  - c) Balustrades
  - d) Walkways

**Buy our 25-page summarized study guide for R600 which has the answer sheet to the above NHBRC test questions to guarantee a 100% success rate with the preparation of your exam. Click back to see option 1, 2 or 3 for more info. Deposit funds into FIXONATE's FNB Acc No: 62686499924, Code 250655 to receive the SMS Password to the study guide. Please use your cellphone number as the deposit reference. Call 072 547 5231 (24/7) for more information.**

(49). Which one of the following [REDACTED] can be placed in fresh water/wet soil conditions?

- a) [REDACTED]
- b) [REDACTED]
- c) [REDACTED]

(50). What is [REDACTED] ?

- a) [REDACTED] is the process of cutting, skidding and processing trees to produce timber and pulp to supply the world's markets for construction and other products.
- b) It is the process of treating trees with insecticides to avoid termites from eating through the wood.
- c) It is the process of drying trees for charcoal making.
- d) All of the above.

(51). What are the 3 key facets of [REDACTED] construction?

- a) [REDACTED] treatment
- b) [REDACTED] Grades
- c) Good [REDACTED] practice
- d) All of the above

(52). Which one of the following materials can [REDACTED]

- a) Plywood
- b) OSB (Oriental Standard Board)
- c) Engineered timber (Hard Board)
- d) All of the above

(53). Where can [REDACTED] be applied?

- a) Bracing
- b) Purlins
- c) Rafters
- d) None of the above

**Buy our 25-page summarized study guide for R600 which has the answer sheet to the above NHBRC test questions to guarantee a 100% success rate with the preparation of your exam. Click back to see option 1, 2 or 3 for more info. Deposit funds into FIXONATE's FNB Acc No: 62686499924, Code 250655 to receive the SMS Password to the study guide. Please use your cellphone number as the deposit reference. Call 072 547 5231 (24/7) for more information.**

- (54). What does [REDACTED] condition mean?
- a) A white mineral often tinted by impurities, found in sedimentary rocks and veins. It is used in the manufacture of cement and as a building stone (marble).
  - b) An acidic type of soil.
  - c) A rock formed from volcanic conditions.
  - d) [REDACTED]
- (55). What types of [REDACTED] ?
- a) loam & rock soil
  - b) Peat
  - c) Clay
  - d) Sand and Gravel
- (56). Which one of the following is the [REDACTED] even for a [REDACTED] [REDACTED]
- a) loam & rock soil
  - b) Peat
  - c) Clay
  - d) Sand and Gravel
- (57). In terms of the NHBRC [REDACTED], what is a [REDACTED] type classification?
- a) Contaminated [REDACTED]
  - b) Fills, Marshes, reclaimed areas & very soft areas
  - c) [REDACTED]
  - d) All of the above

Please Note, always refer to the [REDACTED]  
[REDACTED]

- (58). What type of [REDACTED] is needed on a [REDACTED] classified area?
- a) A strip foundation
  - b) A Raft, Mat or Slab on the ground foundation
  - c) Dolomite foundation
  - d) A pad foundation

**Buy our 25-page summarized study guide for R600 which has the answer sheet to the above NHBRC test questions to guarantee a 100% success rate with the preparation of your exam. Click back to see option 1, 2 or 3 for more info. Deposit funds into FIXONATE's FNB Acc No: 62686499924, Code 250655 to receive the SMS Password to the study guide. Please use your cellphone number as the deposit reference. Call 072 547 5231 (24/7) for more information.**

- (59). Which one of the following soils [REDACTED] when [REDACTED] added?
- a) Clay soil site classification "H"
  - b) Rocks site classification "R"
  - c) Dolomitic areas site classification "P"
  - d) None of the above
- (60). What is an [REDACTED]
- a) [REDACTED] means soil fill, which is wetted or dried to its near optimum moisture content, placed in lifts of twelve (12) inches or less and each lift compacted to a minimum percentage compaction as specified by a geotechnical engineer.
  - b) [REDACTED] is soil or aggregate materials derived from on-property or off- property locations which has been placed on the property to meet specific engineering requirements for the construction of buildings, utility lines, roadway sub-grade, or other structures
  - c) All of the above.
  - d) None of the above.
- (61). What should the minimum distance be, between a [REDACTED] ?
- a) 3 Metres
  - b) 5 Metres
  - c) 10 Metres
  - d) 15 Metres
- (62). What should the minimum clearance be when a [REDACTED] crosses a [REDACTED] [REDACTED]
- a) 300mm
  - b) 500mm
  - c) 600mm
  - d) 1000mm or 1 Meter

**Buy our 25-page summarized study guide for R600 which has the answer sheet to the above NHBRC test questions to guarantee a 100% success rate with the preparation of your exam. Click back to see option 1, 2 or 3 for more info. Deposit funds into FIXONATE's FNB Acc No: 62686499924, Code 250655 to receive the SMS Password to the study guide. Please use your cellphone number as the deposit reference. Call 072 547 5231 (24/7) for more information.**

- (63). Service trenches shall not be [REDACTED] [REDACTED] within how many meters?
- a) 1.0 Meters
  - b) 1.5 Meters
  - c) 2.0 Meters
  - d) 2.5 Meters
- (64). In [REDACTED] construction, the [REDACTED] not be less than?
- a) 50mm
  - b) 110mm
  - c) 150mm
  - d) 200mm
- (65). In the [REDACTED] construction, [REDACTED] shall not exceed?
- a) 50mm
  - b) 110mm
  - c) 150mm
  - d) 200mm
- (66). In the [REDACTED] what is the strength of [REDACTED] in the [REDACTED] ?
- a) 5 MPa
  - b) 10 MPa
  - c) 15 MPa
  - d) 25 MPa
- (67). In a [REDACTED] construction, [REDACTED] shall at least be required to be spaced [REDACTED] with a [REDACTED] spacing of?
- a) 0.5 Meters
  - b) 1.0 Meters
  - c) 1.5 Meters
  - d) 2.0 Meters
- (68). What is the minimum [REDACTED] ?
- a) 30mm
  - b) 50mm
  - c) 75mm
  - d) 110mm

**Buy our 25-page summarized study guide for R600 which has the answer sheet to the above NHBRC test questions to guarantee a 100% success rate with the preparation of your exam. Click back to see option 1, 2 or 3 for more info. Deposit funds into FIXONATE's FNB Acc No: 62686499924, Code 250655 to receive the SMS Password to the study guide. Please use your cellphone number as the deposit reference. Call 072 547 5231 (24/7) for more information.**

- (69). Where [REDACTED] not allowed?
- a) At an intersection of a wall
  - b) In the middle of the wall
  - c) All of the above
  - d) None of the above

(70). Masonry walling shall not [REDACTED]

[REDACTED]

[REDACTED]

[REDACTED]

[REDACTED]

[REDACTED]

- a) [REDACTED] perpend joint
- b) A vertical chase
- c) A control joint
- d) A bedding joint

**Buy our 25-page summarized study guide for R600 which has the answer sheet to the above NHBRC test questions to guarantee a 100% success rate with the preparation of your exam. Click back to see option 1, 2 or 3 for more info. Deposit funds into FIXONATE's FNB Acc No: 62686499924, Code 250655 to receive the SMS Password to the study guide. Please use your cellphone number as the deposit reference. Call 072 547 5231 (24/7) for more information.**

- (75). What is the name given to a [REDACTED] ?
- a) A perpend joint
  - b) A vertical chase
  - c) A control joint
  - d) A bedding joint
- (76). What is the maximum depth of [REDACTED] block?
- a) 1/6
  - b) 16mm
  - c) 16%
  - d) All of the above
- (77). [REDACTED] in a 100mm block?
- a) 6mm
  - b) 10mm
  - c) 16mm
  - d) 33mm
- (78). [REDACTED] ... [REDACTED]
- a) 1/4 of the thickness of the wall
  - b) 1/3 of the thickness of the wall
  - c) 1/2 of the above
  - d) None of the above
- (79). [REDACTED] dig into the thickness of the wall?
- a) 33mm
  - b) 66mm
  - c) 99mm
  - d) 120mm
- (80). After how many days can [REDACTED] on side walls, columns & vertical faces of beams?
- a) Between 2 to 4 days or as per engineer's discretion
  - b) 7 days
  - c) 14 days
  - d) 21 days

**Buy our 25-page summarized study guide for R600 which has the answer sheet to the above NHBRC test questions to guarantee a 100% success rate with the preparation of your exam. Click back to see option 1, 2 or 3 for more info. Deposit funds into FIXONATE's FNB Acc No: 62686499924, Code 250655 to receive the SMS Password to the study guide. Please use your cellphone number as the deposit reference. Call 072 547 5231 (24/7) for more information.**



- (81). After what period can [REDACTED] with a bearing span of between [REDACTED]
- a) Between 2 to 4 days or as per engineer's discretion
  - b) 7 days
  - c) 14 days
  - d) 21 days
- (82). After what period can [REDACTED] equal to or greater than [REDACTED]
- a) Between 2 to 4 days or as per engineer's discretion
  - b) 7 days
  - c) 14 days
  - d) 21 days
- (83). After what period can [REDACTED]
- a) 3 days
  - b) 7 days
  - c) 14 days
  - d) 21 days
- (84). What is the [REDACTED] above a supporting element (foundation, slab or lintel)?
- a) 5mm
  - b) 10mm
  - c) 15mm
  - d) 35mm
- (85). What is the [REDACTED] above a supporting element (foundation, slab or lintel)?
- a) 5mm
  - b) 10mm
  - c) 15mm
  - d) 35mm

**Buy our 25-page summarized study guide for R600 which has the answer sheet to the above NHBRC test questions to guarantee a 100% success rate with the preparation of your exam. Click back to see option 1, 2 or 3 for more info. Deposit funds into FIXONATE's FNB Acc No: 62686499924, Code 250655 to receive the SMS Password to the study guide. Please use your cellphone number as the deposit reference. Call 072 547 5231 (24/7) for more information.**

- (86). What is the minimum [REDACTED] for a butterfly wall type tie?
- a) 2.0mm
  - b) 2.5mm
  - c) 3.0mm
  - d) 4.5mm
- (87). In [REDACTED] [REDACTED] units, [REDACTED] shall generally be provided at minimum intervals of?
- a) 4m wide
  - b) 6m wide
  - c) 10m wide
  - d) 15m wide
- (88). What is the [REDACTED] permitted by SANS10145 for [REDACTED] where reinforcement is [REDACTED] ?
- a) 4m wide
  - b) 6m wide
  - c) 9m wide
  - d) 12m wide
- (89). Which method can be used to [REDACTED] [REDACTED] ?
- a) Galvanized steel & wires
  - b) Wall ties and mortar
  - c) Steel wires
  - d) All of the above
- (90). Where should a [REDACTED]
- a) Inwards
  - b) Upside down
  - c) Outwards
  - d) None of the above

**Buy our 25-page summarized study guide for R600 which has the answer sheet to the above NHBRC test questions to guarantee a 100% success rate with the preparation of your exam. Click back to see option 1, 2 or 3 for more info. Deposit funds into FIXONATE's FNB Acc No: 62686499924, Code 250655 to receive the SMS Password to the study guide. Please use your cellphone number as the deposit reference. Call 072 547 5231 (24/7) for more information.**

(91). What is the minimum height of a window from roof to the upper top of the window?

- a) 450mm
- b) 600mm
- c) 800mm
- d) 1100mm

(92). What is the [REDACTED] for the [REDACTED] of a [REDACTED]?

- a) 15 m<sup>2</sup>
- b) 30 m<sup>2</sup>
- c) 45 m<sup>2</sup>
- d) 60 m<sup>2</sup>

(93). What is the minimum [REDACTED]?

- a) 1.8M
- b) 2.1M
- c) 2.4M
- d) 6.0M

(94). What is the maximum [REDACTED] other than a kitchen, scullery or laundry?

- a) 1.8M
- b) 2.1M
- c) 2.4M
- d) 6.0M

(95). What is the minimum [REDACTED] of a [REDACTED]?

- a) 1.2M
- b) 1.8M
- c) 2.0M
- d) 2.4M

**Buy our 25-page summarized study guide for R600 which has the answer sheet to the above NHBRC test questions to guarantee a 100% success rate with the preparation of your exam. Click back to see option 1, 2 or 3 for more info. Deposit funds into FIXONATE's FNB Acc No: 62686499924, Code 250655 to receive the SMS Password to the study guide. Please use your cellphone number as the deposit reference. Call 072 547 5231 (24/7) for more information.**

- (96). What is the maximum [REDACTED]?
- a) 100 mm
  - b) 150 mm
  - c) 200 mm
  - d) 300 mm
- (97). What is the minimum [REDACTED] a [REDACTED] measured vertically from the [REDACTED] to the [REDACTED]?
- a) 1.5 Meters Measure vertically from pitch line.
  - b) 2.1 Meters Measure vertically from pitch line.
  - c) 2.5 Meters Measure vertically from pitch line.
  - d) 3.0 Meter Measures vertically from pitch line.
- (98). How much must the [REDACTED]?
- a) 100mm
  - b) 150mm
  - c) 300mm
  - d) 400mm
- (99). When is a [REDACTED] used on a [REDACTED] that is prone to [REDACTED]
- a) In higher moisture content conditions
  - b) In low moisture content conditions
  - c) During the rainy season
  - d) All the time
- (100). What type of wall ties are used on a [REDACTED]
- a) Butterfly wall & Fishtail wall ties
  - b) Remedial wall ties
  - c) Block wall ties
  - d) Stainless steel wall tiles
- (101). If an [REDACTED] is fitted through the [REDACTED] what's used to fill the [REDACTED]
- a) A PVC
  - b) A bituminous felt membrane
  - c) Polyethylene plastic
  - d) Self-adhesive tape

**Buy our 25-page summarized study guide for R600 which has the answer sheet to the above NHBRC test questions to guarantee a 100% success rate with the preparation of your exam. Click back to see option 1, 2 or 3 for more info. Deposit funds into FIXONATE's FNB Acc No: 62686499924, Code 250655 to receive the SMS Password to the study guide. Please use your cellphone number as the deposit reference. Call 072 547 5231 (24/7) for more information.**

- (102). What is the minimum [REDACTED] over the outside of the [REDACTED]?
- a) 50mm
  - b) 100mm
  - c) 150mm
  - d) 300mm
- (103). What should the [REDACTED] be when [REDACTED] concrete is placed over above the [REDACTED]
- a) 50 mm
  - b) 100mm
  - c) 150mm
  - d) 300mm
- (104). What does [REDACTED]
- a) Type of reinforcement and its diameter
  - b) The type of supplier
  - c) The year it was manufactured
  - d) The number of years guaranteed
- (105). Where are [REDACTED] on [REDACTED]?
- a) On top of the underlayment at all rakes, and below or on top of the underlayment at the eaves.
  - b) Underneath the underlayment at all rakes and above of the underlayment in eaves.
  - c) Any of the above.
  - d) None of the above.
- (106). What is the correct size of [REDACTED]
- a) 45x45mm
  - b) [REDACTED]
  - c) 48x48mm
  - d) 60x60mm

**Buy our 25-page summarized study guide for R600 which has the answer sheet to the above NHBRC test questions to guarantee a 100% success rate with the preparation of your exam. Click back to see option 1, 2 or 3 for more info. Deposit funds into FIXONATE's FNB Acc No: 62686499924, Code 250655 to receive the SMS Password to the study guide. Please use your cellphone number as the deposit reference. Call 072 547 5231 (24/7) for more information.**

(107). What are the [REDACTED] dimensions of a [REDACTED] supporting the tie beam and rafters?

- a) [REDACTED]
- b) 40x120x80mm
- c) 60x100x100mm
- a) 60x120x80mm

(108). What is the name given to a [REDACTED] the roof timber situated from wall plate to roof covering, that is used to prevent [REDACTED]?

- a) A Beam filling
- b) Engineering filling materials.
- c) Sand Filling.
- d) None of the above.

(109). Purlins and rafter splices should not be [REDACTED]

- a) 0.5m
- b) 1.0m
- c) 1.5m
- d) 2.0m

(110). What is [REDACTED] part of the [REDACTED] structure called?

- a) A Ridge Board
- b) Rafter
- c) Purlin
- d) Joist

(111). What is the name given to a [REDACTED] attached to an unplaced material [REDACTED] in order to support the [REDACTED]

- a) Purlin
- b) A beam
- c) A rafter
- d) Joist

**Buy our 25-page summarized study guide for R600 which has the answer sheet to the above NHBRC test questions to guarantee a 100% success rate with the preparation of your exam. Click back to see option 1, 2 or 3 for more info. Deposit funds into FIXONATE's FNB Acc No: 62686499924, Code 250655 to receive the SMS Password to the study guide. Please use your cellphone number as the deposit reference. Call 072 547 5231 (24/7) for more information.**

(112). What is the name given to a [redacted] attached to an unplated [redacted] to a [redacted] in order to support the [redacted]?

- a) Purlin
- b) A beam
- c) A rafter
- d) Joist

(113). What is the minimum [redacted]?

- a) 75mm
- b) 150mm
- c) 300 mm
- d) 600 mm

(114). What is the minimum length of [redacted]?

- a) 75mm
- b) 150mm
- c) 300mm
- d) 600mm

(115). What is the [redacted] flutes?

- a) 75mm
- b) 150mm
- c) 300mm
- d) 600mm

(116). What is the [redacted] for a heavy roof type on a solid unit?

- a) 150mm
- b) 300mm
- c) 400mm
- d) 600mm

(117). What is the [redacted]?

- a) 10 degrees
- b) 17 degrees
- c) 25 degrees
- d) 45 degrees

**Buy our 25-page summarized study guide for R600 which has the answer sheet to the above NHBRC test questions to guarantee a 100% success rate with the preparation of your exam. Click back to see option 1, 2 or 3 for more info. Deposit funds into FIXONATE's FNB Acc No: 62686499924, Code 250655 to receive the SMS Password to the study guide. Please use your cellphone number as the deposit reference. Call 072 547 5231 (24/7) for more information.**

- (118). [REDACTED] shall be tied down to the supporting walls and columns by means of
- 4 mm brick force
  - Galvanized steel straps or Galvanized Steel Wires
  - Roof wire drilled into the wall
  - Galvanized steel wires & drilled into the wall.
- (119). What is the purpose of a [REDACTED] within the home building process?
- To evaluate the geology plus the hydrogeology of the site
  - To examine geotechnical information pertaining to the site
  - To determine the depth of any fill that might be present
  - All of the above
- (120). Who is the most competent person that should design the [REDACTED] ?
- Civil engineer
  - A Geotechnical engineer
  - An NHBRC inspector
  - None of the above
- (121). Who is the competent person that should inspect the [REDACTED] during the implementation of the solution?
- Geotechnical engineer
  - Civil engineer
  - NHBRC Inspector
  - None of the above
- (122). Who shall install a [REDACTED] on top of a flat roof?
- A civil engineer
  - A competent person
  - An architecture
  - A geotechnical manager
- (123). Who is responsible for all the [REDACTED] of a home?
- A civil engineer
  - A competent person
  - An architecture
  - A geotechnical manager

**Buy our 25-page summarized study guide for R600 which has the answer sheet to the above NHBRC test questions to guarantee a 100% success rate with the preparation of your exam. Click back to see option 1, 2 or 3 for more info. Deposit funds into FIXONATE's FNB Acc No: 62686499924, Code 250655 to receive the SMS Password to the study guide. Please use your cellphone number as the deposit reference. Call 072 547 5231 (24/7) for more information.**



(124). The specialist water proofing contractor shall provide a home builder with at least at least...guarantee?

- a) 6 Months
- b) [REDACTED]
- c) 3 years
- d) 5 years

(125). Any person in the business of [REDACTED] can register with the

- a) SABS
- b) NHBRC
- c) CIDB
- d) SARS

COPY RIGHT (FIXONATE)

**Buy our 25-page summarized study guide for R600 which has the answer sheet to the above NHBRC test questions to guarantee a 100% success rate with the preparation of your exam. Click back to see option 1, 2 or 3 for more info. Deposit funds into FIXONATE's FNB Acc No: 62686499924, Code 250655 to receive the SMS Password to the study guide. Please use your cellphone number as the deposit reference. Call 072 547 5231 (24/7) for more information.**